

# FALCON® BEAM 2 ARC colour

## 3,000W/7,000W

- MADE IN GERMANY
- Powder-coated aluminium housing
- Weatherproof (IP44)
- 200,000 lumens output (7,000W)
- 16 bit precision movement

3,000 W | 7,000 W

**The FALCON® BEAM 2 ARC colour** is perfect for large architectural and entertainment installations, including use as a searchlight or long-throw washlight.



FALCON® BEAM ARC colour, 3,000 W



Pan movement 500°  
Tilt movement 240°

### Dimensions 3,000 W

h: 1,320 mm | 52.0 inch  
w: 601 mm | 23.7 inch  
d: 730 mm | 28.7 inch

### Dimensions 7,000 W

h: 1,621 mm | 63.8 inch  
w: 732 mm | 28.8 inch  
d: 900 mm | 35.4 inch

Pivoting angle: 240°

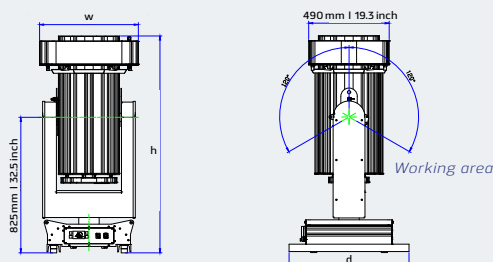

Pivoting angle: 240°

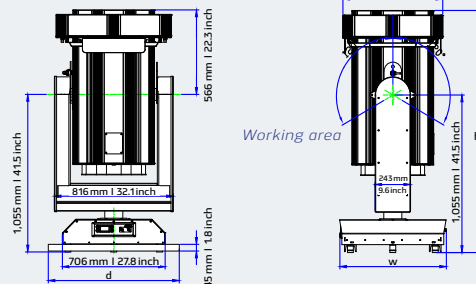

Technical subjects to alterations.

Technical specifications	FALCON® BEAM 2 ARC colour 3,000 W	FALCON® BEAM 2 ARC colour 7,000 W
<b>Lamp</b>		
Type	OSRAM XBO® 3,000 W	OSRAM Xstage® 7,000 W
Colour temperature	6,000 K	
<b>Colour changer system</b>		
Colour changer	Gel scroller with up to 18 single colours	Gel scroller with up to 13 single colours
<b>Reflector</b>		
Material	Nickel with high precision electro-shaped rhodium/dichroic coating	
Diameter	320 mm / 12.6 inch	460 mm / 18.1 inch
<b>Function</b>		
Main functions	Lamp on / off, hot strike, electronic dimmer, electronic / mechanical strobe, douser, zoom, pan / tilt movement 16 bit, reset, colour changer	
Movement	Pan = 500 °, tilt = 240 °	
<b>Control</b>		
Standard DMX protocol	DMX 512 in / out	
DMX channels	13	
<b>Power</b>		
System	Built-in electronic power supply	
Input voltages (other input voltages on request)	90 - 264 VAC, + 5 % / - 5 %, 50/60 Hz, 1-phase	190 - 442 VAC, + 5 % / - 5 %, 50/60 Hz, balanced 3-phase
Power factor	cos $\phi$ > 0.98	
Power consumption	3,300 W	7,500 W
<b>Temperature</b>		
Operating temperature	- 15 °C up to + 42 °C, non-condensed; 5 °F up to 107.6 °F, non-condensed	
<b>Housing</b>		
Material	Powder-coated, non-corrosive aluminium / stainless steel	
Colour	Standard colour: silver-grey, RAL 9006; other RAL-tones possible	
<b>Protection</b>		
Protection rating	IP 44	
<b>Specifications</b>		
Dimensions h x w x d	1,320 x 601 x 730 mm; 52.0 x 23.7 x 28.7 inch	1,621 x 732 x 900 mm; 63.8 x 28.8 x 35.4 inch
Weight	142 kg (313.1 lb)	255 kg (562.2 lb) with steel profile ca. 236 kg (520.3 lb) without steel profile

# COLOUR STRING STANDARD

## FALCON® BEAM 2 ARC colour 3,000W

		Rosco Supergel HT (Standard!)		Comparative value: LEE Filters
No.	DMX channel		SG No.	LEE HT No.
1	0 - 7		.000 Clear	.000 Clear
2	8 - 22		.205 Half CT Orange (e-colour+)	.205 Half CT Orange
3	23 - 37		.204 Full CT Orange (e-colour+)	.204 Full CT Orange
4	38 - 52		.027 Medium Red	.027 Medium Red
5	53 - 67		.056 Gypsy Lavender	.180 Dark Lavender
6	68 - 82		.021 Golden Amber	.021 Golden Amber
7	83 - 97		.067 Light Sky Blue	.165 Daylight Blue
8	98 - 112		.010 Medium Yellow	.010 Medium Yellow
9	113 - 127		.079 Bright Blue	.079 Just Blue
10	128 - 142		.073 Peacock Blue	.115 Peacock Blue
11	143 - 157		.049 Medium Purple	.126 Mauve
12	158 - 172		.032 Medium Salmon Pink	.193 Rosy Amber
13	173 - 187		.089 Moss Green	.122 Fern Green
14	188 - 201		.371 Theatre Booster 1	
15	202 - 217		.355 Pale Violet	.142 Pale Violet
16	218 - 230		.382 Congo Blue	.181 Congo Blue
17	231 - 247		.095 Medium Blue Green	.116 Medium Blue Green
18	248 - 255		.035 Light Pink	.035 Light Pink

All colours describe examples of design. Computer graphics and screens can give you only a rough sense of the colour. The real colours depending on several preconditions like e.g. conditions of illuminated areas, adjustments in power and brightness of a light source and the ambient light. Technical subjects to alterations.

# COLOUR STRING STANDARD

## FALCON® BEAM 2 ARC colour 7,000W

		Rosco Supergel HT (Standard!)		Comparative value: LEE Filters
No.	DMX channel		SG No.	LEE HT No.
1	0 - 10		.000 Clear	.000 Clear
2	11 - 31		.204 Full CT Orange (e-colour+)	.204 Full CT Orange
3	32 - 52		.026 Light Red	.026 Bright Red
4	53 - 73		.355 Pale Violet	.142 Pale Violet
5	74 - 94		.022 Deep Amber	.022 Dark Amber
6	95 - 115		.079 Bright Blue	.079 Just Blue
7	116 - 136		.010 Medium Yellow	.010 Medium Yellow
8	137 - 157		.089 Moss Green	.122 Fern Green
9	158 - 178		.049 Medium Purple	.126 Mauve
10	179 - 199		.073 Peacock Blue	.115 Peacock Blue
11	200 - 220		.032 Medium Salmon Pink	.193 Rosy Amber
12	221 - 241		.067 Light Sky Blue	.352 Glacier Blue
13	242 - 255		.000 Clear	.000 Clear

All colours describe examples of design. Computer graphics and screens can give you only a rough sense of the colour. The real colours depending on several preconditions like e.g. conditions of illuminated areas, adjustments in power and brightness of a light source and the ambient light. Technical subjects to alterations.

# DMX CHART

## FALCON® BEAM 2 ARC colour 3,000W

FALCON® BEAM 2 ARC colour 3,000W (Vers. Falc C24)						
DMX channel	Function	MODE 1		MODE 2		
		DMX Parameter	Default	DMX Parameter	Default	
1	PAN coarse	0 - 255 (0 - 100%) 0° - 500°	127	0 - 255 (0 - 100%) 0° - 500°	127	
2	PAN fine	0 - 255 (0 - 100%) 0° - 2° fine	127	0 - 255 (0 - 100%) 0° - 2° fine	127	
3	TILT coarse	0 - 255 (0 - 100%) 0° - 240°	127	0 - 255 (0 - 100%) 0° - 234	127	
4	TILT fine	0 - 255 (0 - 100%) 0° - 2° Fine	127	0 - 255 (0 - 100%) 0° - 2° Fine	127	
5	Zoom	0 - 255 (0 - 100%) Min. zoom - max. zoom	127	0 - 255 (0 - 100%) Min. zoom - max. zoom	127	
6	Reserved		0		0	
7	Reserved		0		0	
8	Lamp off/on*	0 - 20 (0 - 8%) Idle	0	0 - 20 (0 - 8%) Idle	0	
		25 - 50 (10 - 20%) Lamp off		25 - 50 (10 - 20%) Lamp off		
		78 - 100 (31 - 39%) Lamp on		78 - 100 (31 - 39%) Lamp on		
	Reset*	126 - 150 (50 - 59%) Fixture reset		126 - 150 (50 - 59%) Fixture reset		
		155 - 160 (61 - 63%) Pan reset		155 - 160 (61 - 63%) Pan reset		
		165 - 170 (65 - 67%) Tilt reset		165 - 170 (65 - 67%) Tilt reset		
		175 - 180 (69 - 71%) Zoom reset		175 - 180 (69 - 71%) Zoom reset		
	Force shutter open			191 - 199 (75 - 78%) Lock shutter in open position (Function is active as long as value is sent by control desk. When released, shutter will immediately follow dimmer values.)		
Fan on*	200 - 255 (79 - 100%) Fan on	200 - 255 (79 - 100%) Fan on				
9	Intensity (Elec. dimmer/ Dimmer)	000 - 255 (0 - 100%) = 30-100% Intensity	255	000 - 255 (0 - 100%) = 0-100% Intensity	0	
10	Electronic strobe	000 - 020 (0 - 8%) Strobe disabled	0	000 - 003 (0 - 2%) Open	0	
				004 - 103 (3 - 40%) Strobe 0.25Hz - 25Hz		004 - 103 (3 - 40%) Strobe 1.8Hz - 2.1Hz
				104 - 107 (41 - 42%) Closed		104 - 107 (41 - 42%) Closed
				108 - 132 (43 - 52%) Pulse open		108 - 132 (43 - 52%) Pulse open
				133 - 157 (53 - 62%) Pulse closed		133 - 157 (53 - 62%) Pulse closed
		158 - 160 (63%) Random slow		158 - 160 (63%) Random slow		
		161 - 163 (64%) Random medium		161 - 163 (64%) Random medium		
		164 - 166 (65%) Random fast		164 - 166 (65%) Random fast		
		167 - 169 (66 - 67%) Open		167 - 169 (66 - 67%) Open		
		21 - 255 (9 - 100%) Strobe 0.2Hz - 25Hz		128 - 255 (51 - 100%) Strobe 0.18Hz - 2.1Hz		
11	Mechanical dimmer / Mechanical strobe	000 - 127 (0 - 50%) Closed - Open	0	000 - 003 (0 - 2%) Open	0	
		128 - 255 (51 - 100%) Strobe 0.18Hz - 2.1Hz		004 - 103 (3 - 40%) Strobe 1.8Hz - 2.1Hz		
				104 - 107 (41 - 42%) Closed		
				108 - 132 (43 - 52%) Pulse open		
				133 - 157 (53 - 62%) Pulse closed		
				158 - 160 (63%) Random slow		
				161 - 163 (64%) Random medium		
				164 - 166 (65%) Random fast		
167 - 169 (66 - 67%) Open						
12	Colour changer	See colour sheet on page 3	0	See colour sheet on page 3		
13	(Future use)		0		0	

\*Hold value for 5 sec. Technical subjects to alterations.

# DMX CHART

## FALCON® BEAM 2 ARC colour 7,000W

FALCON® BEAM 2 ARC colour 7,000W (Vers. Falc C24)						
DMX channel	Function	MODE 1		MODE 2		
		DMX Parameter	Default	DMX Parameter	Default	
1	PAN coarse	0 - 255 (0 - 100%) 0° - 500°	127	0 - 255 (0 - 100%) 0° - 500°	127	
2	PAN fine	0 - 255 (0 - 100%) 0° - 2° fine	127	0 - 255 (0 - 100%) 0° - 2° fine	127	
3	TILT coarse	0 - 255 (0 - 100%) 0° - 240°	127	0 - 255 (0 - 100%) 0° - 234°	127	
4	TILT fine	0 - 255 (0 - 100%) 0° - 2° fine	127	0 - 255 (0 - 100%) 0° - 2° fine	127	
5	Zoom	0 - 255 (0 - 100%) min. zoom - max. zoom	127	0 - 255 (0 - 100%) min. zoom - max. zoom	127	
6	Reserved					
7	Reserved					
8	Lamp off/on*	0 - 20 (0 - 1%) Idle	0	0 - 20 (0 - 1%) Idle	0	
		25 - 50 (10 - 20%) Lamp off		25 - 50 (10 - 20%) Lamp off		
		78 - 100 (31 - 40%) Lamp on		78 - 100 (31 - 40%) Lamp on		
	Reset*	126 - 150 (50 - 59%) Fixture reset		126 - 150 (50 - 59%) Fixture reset		
		155 - 160 (61 - 63%) PAN reset		155 - 160 (61 - 63%) PAN reset		
		165 - 170 (65 - 67%) TILT reset		165 - 170 (65 - 67%) TILT reset		
		175 - 180 (69 - 71%) Zoom reset		175 - 180 (69 - 71%) Zoom reset		
Force shutter open	191 - 199 (75 - 78%) Lock shutter in open position (Function is active as long as value is sent by control desk. When released, shutter will immediately follow dimmer values.)					
Fan on**	200 - 255 (79 - 100%) Fan on	200 - 255 (79 - 100%) Fan on				
9	Intensity (elec. Dimmer/Dimmer)	000 - 255 (0 - 100%) = 0-100% Intensity	0	000 - 255 = 0-100% Intensity	0	
10	Electronic strobe	000 - 020 (0 - 8%) Strobe disabled  021 - 255 (9 - 100%) Strobe 0,2Hz - 25Hz	0	000 - 003 (0 - 2%) Open	0	
				004 - 103 (3 - 40%) Strobe 0,25Hz - 25Hz		
				104 - 107 (41 - 42%) Closed		
				108 - 132 (43 - 52%) Pulse open		
				133 - 157 (53 - 62%) Pulse closed		
				158 - 160 (63%) Random slow		
				161 - 163 (64%) Random medium		
				164 - 166 (65%) Random fast		
				167 - 169 (66 - 67%) Open		
11	Douser  Mechanical strobe	000 - 127 (0 - 50%) Douser closed - Douser open  128 - 255 (51 - 100%) Strobe 0.18Hz - 2.1Hz closed	0	000 - 003 (0 - 2%) Open	0	
				004 - 103 (3 - 40%) Strobe 0,18Hz - 2,1Hz		
				104 - 107 (41 - 42%) Closed		
				108 - 132 (43 - 52%) Pulse open		
				133 - 157 (53 - 62%) Pulse closed		
				158 - 160 (63%) Random slow		
				161 - 163 (64%) Random medium		
				164 - 166 (65%) Random fast		
				167 - 169 (66 - 67%) Open		
12	Colour changer	See colour sheet on page 4	0	See colour sheet on page 4	0	
13	(Future use)		0		0	

\*Hold value for 5 sec. \*\* Hold value for > 1 sec.

Technical subjects to alterations.

# LIGHT SOURCE

## FALCON® BEAM 2 ARC colour 3,000W

**Osram XBO Xtreme Life** is a short arc with very high luminance for brighter illumination.

- Constant colour temperature 6,000K throughout the entire lamp lifetime
- Easy to maintain
- High arc stability
- Instant light thanks to hot restart function
- Wide dimming range



OSRAM XBO Xtreme Life 3,000W - XBO 3000 W/HS XL OFR								
Electrical data			Dimensions & weight					
Nominal wattage	Nominal current	Current control range	Length	Diameter	Length with base excl. base pins/connection	Light center length (LCL)	Electrode gap cold	Weight
3,000W	100A	60..110A	342mm	60mm	302mm	145mm*	6mm	555g

\*Distance from end of base to tip of electrode (cold)

Photometrical data		
Luminous flux	Luminous intensity	Average luminance
130,000lm	12,000cd	90,000cd/cm <sup>2</sup>

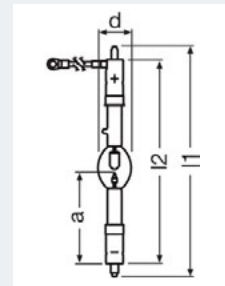

Temperatures & operating conditions	Lifespan	Additional product data		Capabilities	
Max. permitted ambient temp. pinch point	Lifespan	Base anode (standard designation)	Base cathode (standard designation)	Cooling	Burning position
230 °C	2,200hr	SFaX27-9.5	SFa27-7.9	Forced**	s30/p30***

\*\*Vertical and horizontal \*\*\*For vertical burning position: anode (+) on top

Technical subjects to alterations.

# LIGHT SOURCE

## FALCON® BEAM 2 ARC colour 7,000W

**Osram Xstage 7000 W OFR** is a xenon short-arc lamp especially suited for event and architectural lighting. It offers higher luminance due to shortened arc gap.

- Optimized robust base for better stability
- Optimized compact design
- Colour temperature approx. 6,000K (daylight)
- Dimmable
- Hot restart capability



OSRAM Xstage 7000W - Xstage 7000 W OFR						
Electrical data				Photometrical data		
Nominal wattage	Nominal voltage	Lamp current	Current control range	Luminous flux	Luminous intensity	Average luminance
7,000W	40.0V	160A	110..165A	330,000lm	33,000cd	120,000cd/cm <sup>2</sup>

Dimensions				
Diameter	Length	Mounting length	Light center length (LCL)	Electrode gap cold
70mm	400mm	362mm	162.5mm*	8 mm

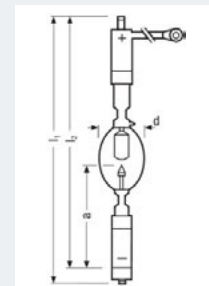

\*Distance from end of base to tip of electrode (cold)

Temperatures & operating conditions	Lifespan	Additional product data		Capabilities	
Max. base temperature	Lifespan	Base anode (standard designation)	Base cathode (standard designation)	Cooling	Operating position
230 °C	1,000hr	SFaX27-9.5	SFc28-27	Forced**	s90

\*\*Vertical and horizontal

Because of their high luminance, UV radiation and high internal pressure in both the hot and cold state, Xstage lamps must only be operated in enclosed lamp casings specially constructed for the purpose. Always use the supplied protective jackets when handling these lamps. They may only be used as open lamps if appropriate safety measures are taken. More information is available on request or can be found in the leaflet included with the lamp or the operating instructions.

Technical subjects to alterations.



# BEAM SPREADS - ZOOM

## FALCON® BEAM 2 ARC colour 3,000W

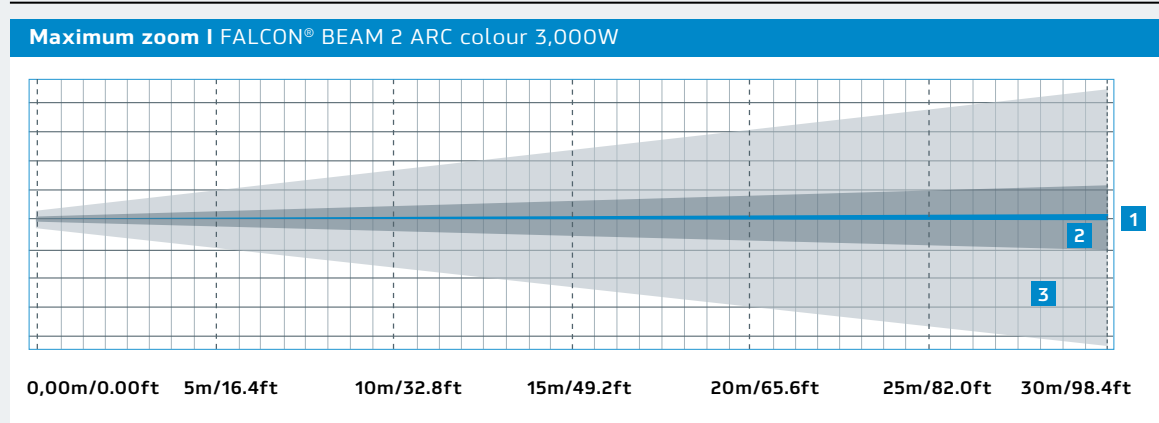

**Photometric data maximum zoom | FALCON® BEAM 2 ARC colour 3,000W**

Zoom	0m / 0ft	5m / 16.4ft	10m / 32.8ft	15m / 49.2ft	20m / 65.6ft	25m / 82.0ft	30m / 98.4ft
<b>1</b> Focussed parallel beam <2.5°	0.32m / 1.05ft	0.34m / 1.12ft	0.36m / 1.18ft	0.38m / 1.25ft	0.40m / 1.31ft	0.42m / 1.38ft	0.44m / 1.44ft
<b>2</b> Maximum zoom angle with full spot 6°	0.32m / 1.05ft	0.43m / 1.41ft	0.87m / 2.85ft	1.30m / 4.26ft	1.74m / 5.71ft	2.17m / 7.11ft	2.60m / 8.53ft
<b>3</b> Maximum zoom angle with centred hole 20°	0.32m / 1.05ft	1.73m / 5.67ft	3.47m / 11.38ft	5.20m / 17.06ft	6.94m / 22.76ft	8.67m / 28.43ft	10.40m / 34.11ft

# BEAM SPREADS - ZOOM

## FALCON® BEAM 2 ARC colour 7,000W

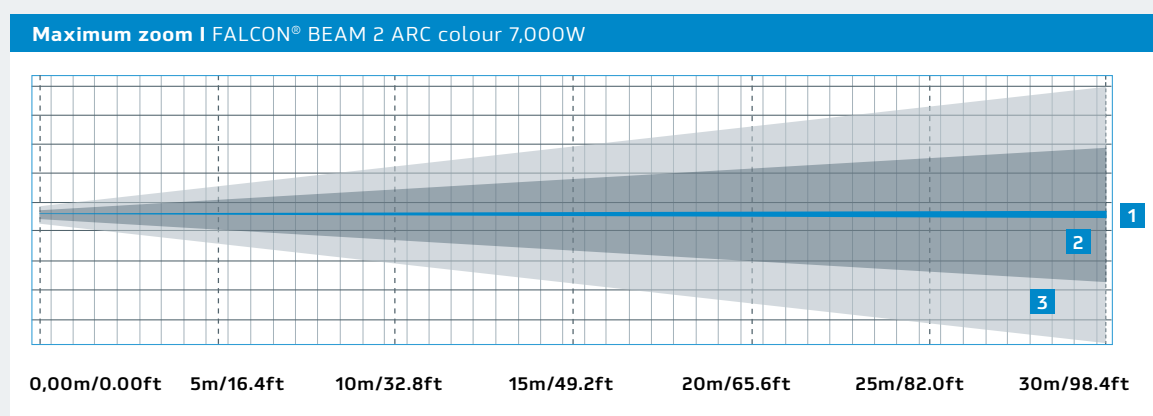

**Photometric data maximum zoom | FALCON® BEAM 2 ARC colour 7,000W**

Zoom	0m / 0ft	5m / 16.4ft	10m / 32.8ft	15m / 49.2ft	20m / 65.6ft	25m / 82.0ft	30m / 98.4ft
<b>1</b> Focussed parallel beam <math><2.5^\circ</math>	0.46m / 1.52ft	0.48m / 1.57ft	0.50m / 1.64ft	0.52m / 1.71ft	0.54m / 1.77ft	0.58m / 1.90ft	0.60m / 1.97ft
<b>2</b> Maximum zoom angle with full spot $11^\circ$	0.46m / 1.52ft	0.88m / 2.90ft	1.76m / 5.80ft	2.65m / 8.70ft	3.53m / 11.59ft	4.41m / 14.49ft	5.30m / 17.38ft
<b>3</b> Maximum zoom angle with centred hole $20^\circ$	0.46m / 1.52ft	1.67m / 5.48ft	3.33m / 10.93ft	5.00m / 16.40ft	6.67m / 21.88ft	8.33m / 27.32ft	10.00m / 32.80ft

Technical subjects to alterations.

Arts Outdoor Lighting Technology GmbH & Co. KG ■ Arberger Hafendamm 22 ■ 28309 Bremen ■ Germany  
■ Fon +49 (0) 421 59 66 09-0 ■ Fax +49 (0) 421 59 66 09-66  
■ info@ao-technology.com ■ www.ao-technology.com

■ December 2018 All of the descriptions, illustrations, diagrams and technical details in this folder describe examples of design or construction and they do not form any element of the contract. Text and photographs are the copyright of Arts Outdoor Lighting Technology GmbH & Co. KG. All rights reserved. The right is reserved to make technical alterations.